



395





# 395

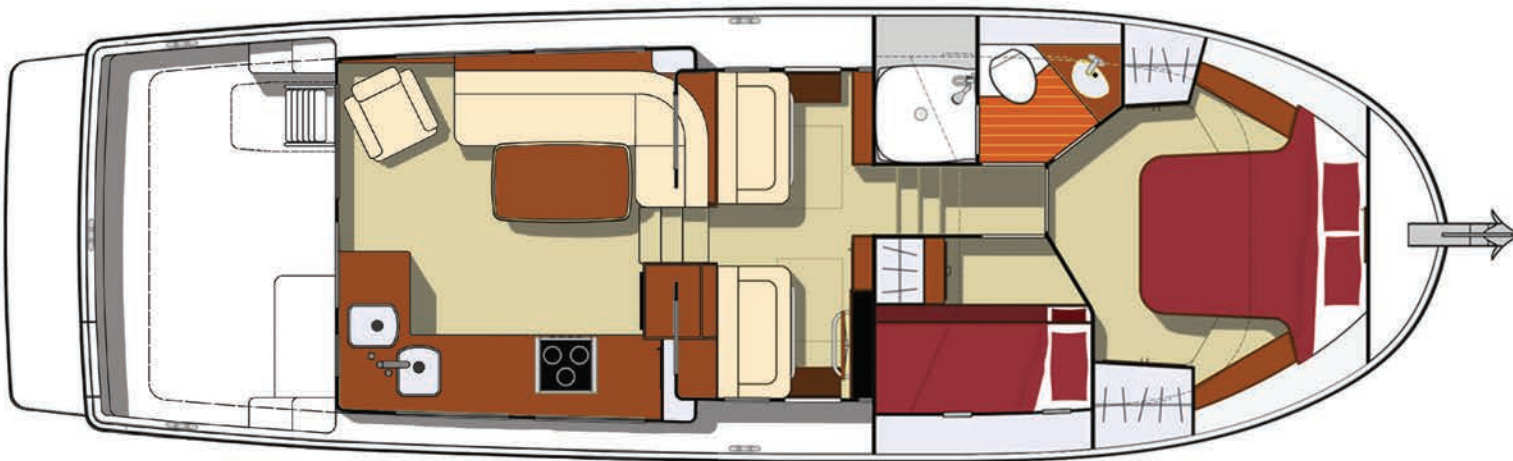

- POWER SINGLE CUMMINS QSB 380
- LOA 41'6"
- LWL 37'
- BEAM 13'3"
- DRAFT 3'5"
- DISP (dry) 21,000 lbs.
- DISP (wet) 25,000 lbs.
- FUEL 400 US GAL
- RANGE 1000 nm approx.  
*(varies with load and cruising conditions)*
- WATER 120 US GAL
- WASTE 45 US GAL
- SLEEPS 7 (2-stateroom), 4 (single cabin)

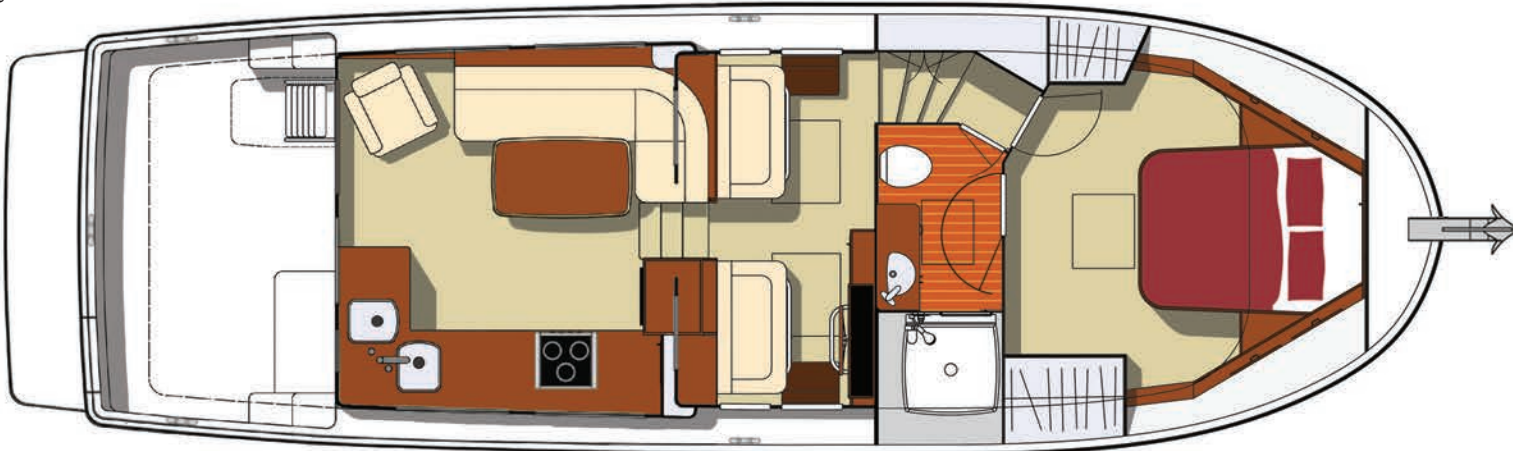

Single Cabin Layout